

Mr. Nigel Reams.
Lumcloon Energy Ltd.
Parsons House,
56 Axis Business Park,
Tullamore,
Co Offaly.
R35 K744

15 February 2022

Re: Letter of consent for Lumcloon Energy limited to include Westmeath County Council owned lands in the townland of Kiltotan and Collinstown, Castlelost, Co Westmeath in a planning application for a GIS substation.

Dear Mr. Reams,

Westmeath County Council consent to Lumcloon Energy Ltd, including Council owned lands at Kiltotan and Collinstown, Castlelost, Co. Westmeath, as an emergency access, in their planning application for a GIS substation.

These lands, being that part of lands contained in Folio No. WH29725F and WH25177F are displayed on the attached **Drawing No. 0347-PL-2000 P1** marked 'X to Y' and consist of a farm access road which was constructed as part of the M6 motorway, off the L51251.

This letter of consent is solely to facilitate the making of the planning application, is without prejudice to the Council's consideration or determination of such planning application or to the Council's requirements in relation to the use and re-instatement of our said lands in the event that the proposed development may be permitted and does proceed.

This letter of consent, which will expire two calendar years from the date on this letter, confers no other rights whatsoever to any party.

Yours sincerely,



Pat Gallagher
Chief Executive

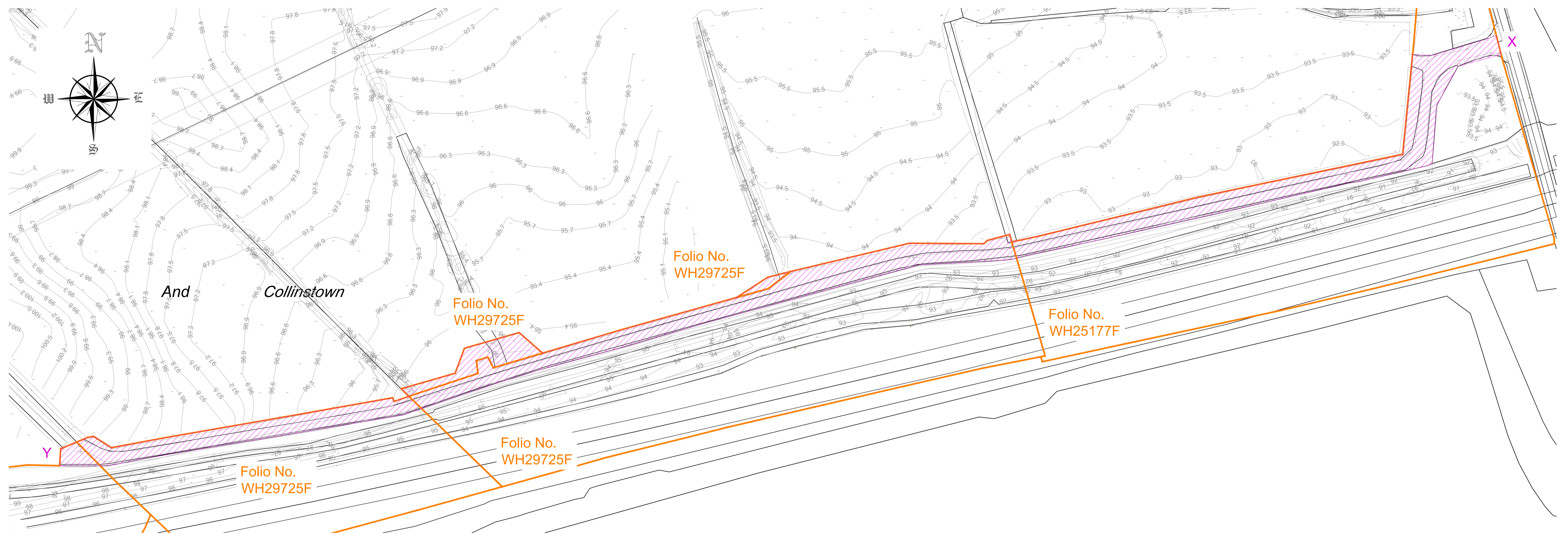
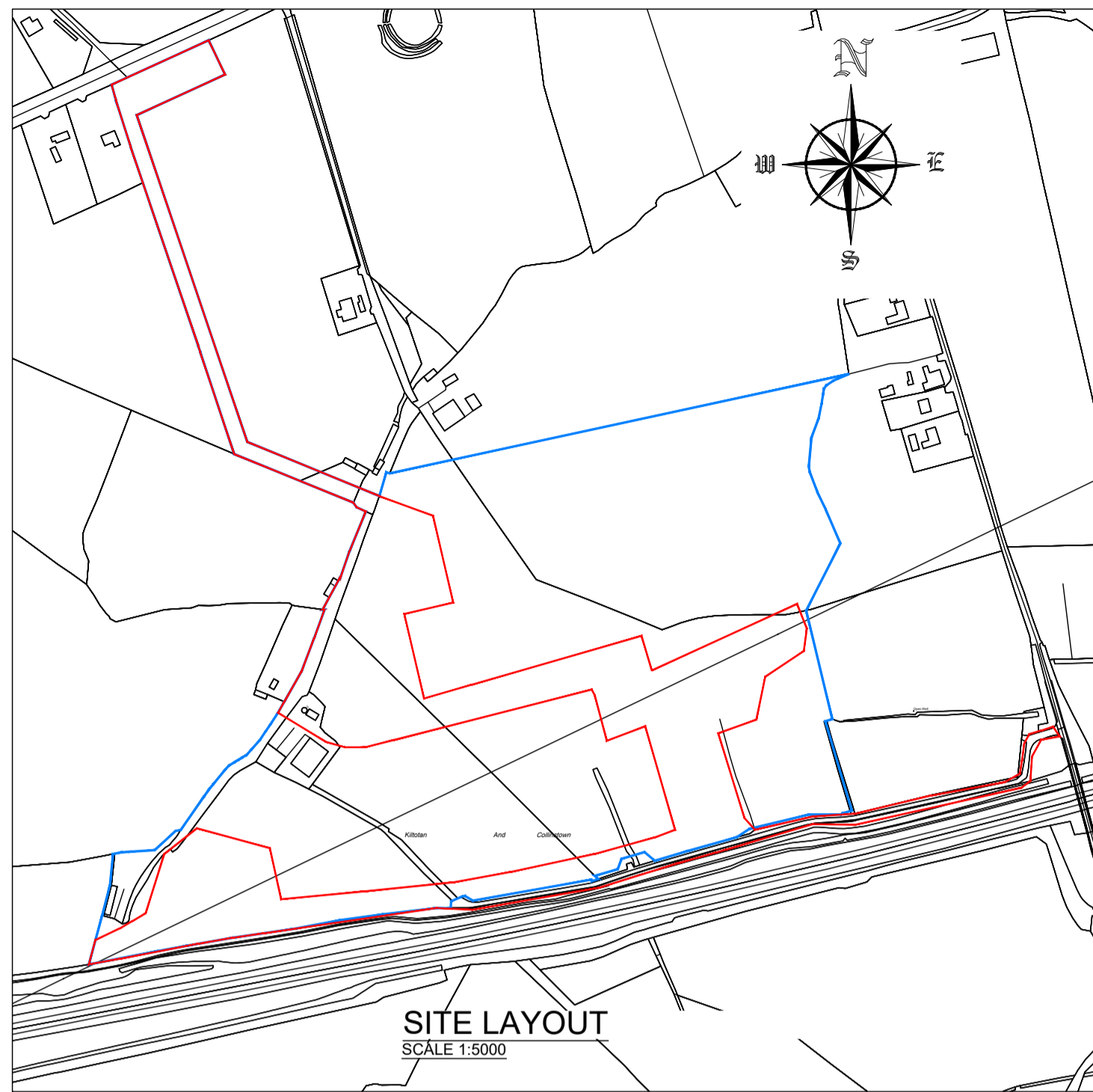

NOTES:
 1 FIGURED DIMENSIONS ONLY TO BE TAKEN FROM THIS DRAWING.
 2 THIS DRAWING TO BE READ IN CONJUNCTION WITH ALL OTHER RELEVANT DRAWINGS AND SPECIFICATIONS.

Rev.	Modifications	By	Date
P1	PLANNING ISSUE	BB	10.02.22

LEGEND:

CONSENT BOUNDARY	
FOLIO BOUNDARY	

© COPYRIGHT OF



Email: info@halston.ie
 Tel: 094 9010111

IHUB BUILDING
WESTPORT ROAD
CASTLEBAR
CO. MAYO,
F23 K162

Client	LUMCLOON ENERGY			Drawn	BB	Checked	WD	Approved	CS
Project	LEL GIS, CASTLELOST CO. WESTMEATH			Date	Feb 2022				
Title	ACCESS ROAD LOCAL AUTHORITY CONSENT			Scales	1:750 (A1)				
Stage	PLANNING			Sheet	1 of 1	Sheet Size	A1		
				Job No.	SEP-0347		Rev	P1	
				Dwg. No.	0347-PL-2000				

Collinstown Farm
Rochfortbridge
County Westmeath

I, **LIAM GAVIN** of Collinstown Farm, Rochfortbridge, County Westmeath, **DO HEREBY CONSENT** to Lumcloon Energy Limited making an application for planning permission on my lands situate at Collinstown Farm, Rochfortbridge, County Westmeath, being the property outlined in blue on the map attached hereto

Dated this *18th* day of *May* - 2021

SIGNED:

Liam Gavin

LIAM GAVIN

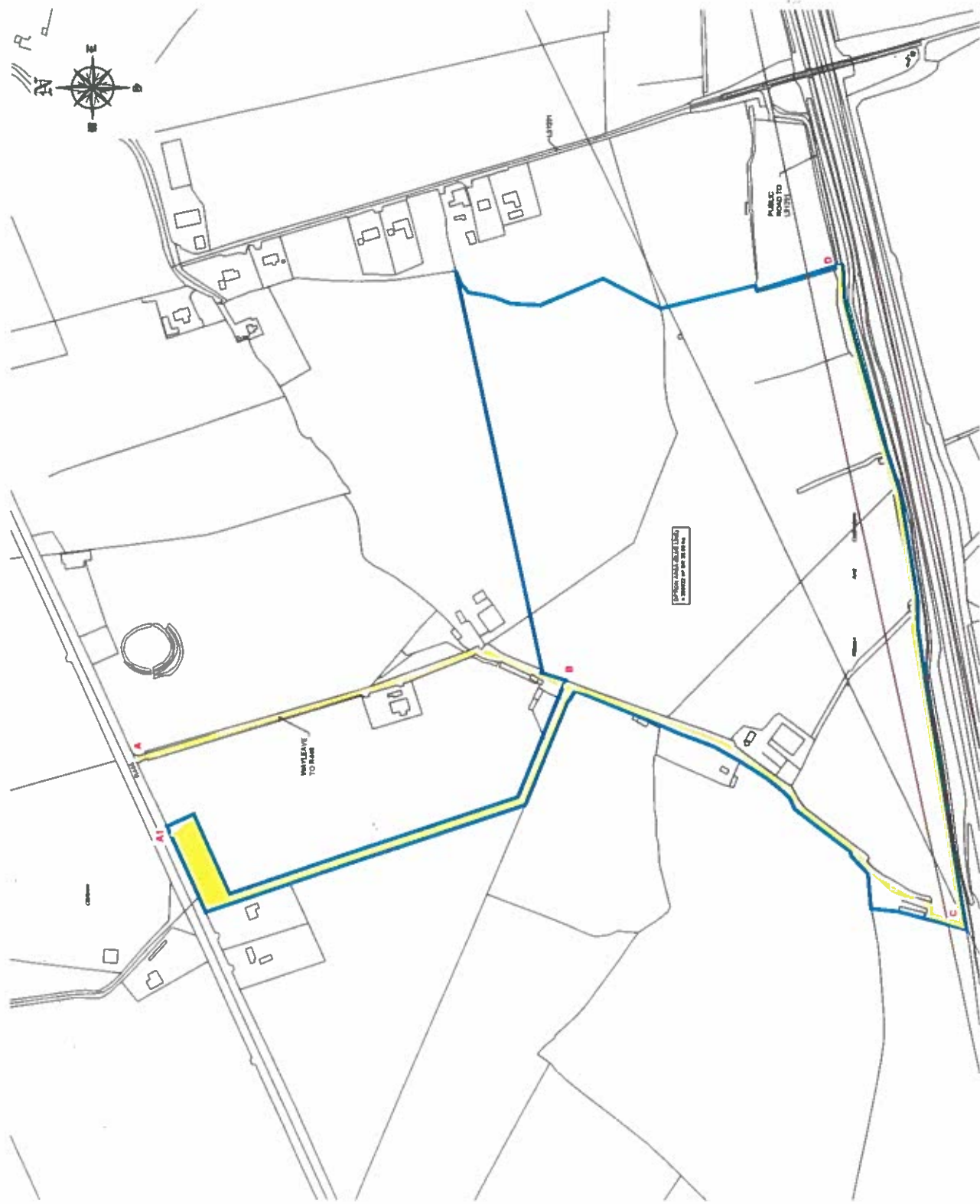
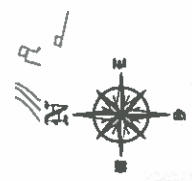

Client	LUMKLOON ENERGY	Drawn	BD	Approved	C8
Project	LEL FUXIGEN CASTLELOST	Date	Apr 2021		
Scale	1:2000 (A1)	Issue	1 of 1		
Title	PROPOSED SITE LAYOUT	Drawn By	BEF-0347		A1
Options		Checked By			P2
Planning		Proj. No.	03/21 PL 000		

HALSTON
 CONSULTANTS
 100 WESTPORT ROAD
 CASTLEBAR
 CO. WICK
 F23 K162
 Email: info@halston.ie
 Tel: 044 909111

Drawn	BD	Checked	BD	Approved	C8
Date	Apr 2021	Issue	1 of 1		
Scale	1:2000 (A1)	Drawn By	BEF-0347		A1
Title	PROPOSED SITE LAYOUT	Checked By			P2
Options		Proj. No.	03/21 PL 000		

HALSTON
 CONSULTANTS
 100 WESTPORT ROAD
 CASTLEBAR
 CO. WICK
 F23 K162
 Email: info@halston.ie
 Tel: 044 909111



Drawn	BD	Checked	BD	Approved	C8
Date	Apr 2021	Issue	1 of 1		
Scale	1:2000 (A1)	Drawn By	BEF-0347		A1
Title	PROPOSED SITE LAYOUT	Checked By			P2
Options		Proj. No.	03/21 PL 000		

NOTES:
 1. This drawing is to be used for planning purposes only.
 2. This drawing is not to be used for construction purposes.
 3. All dimensions are in millimetres unless otherwise stated.